





ENERGY EFFICIENCY

Thermal Transmission Coefficient
 $U_w \geq 0.76$ (W/m²K)

Please consult typology, dimensions and glazing

ACCOUSTIC INSULATION

Maximum glazing: **63 mm**
 Maximum acoustic insulation: **Rw = 44 dB**

CATEGORIES ACHIEVED AT TEST CENTRE

Protection against atmospheric agents

Air permeability (EN 12207): **Class 4**
 Water tightness (EN 12208): **Class E1800**
 Wind resistance (EN 12210): **Class C5**

Reference test 1.23 x 1.48 m / 2 sashes

Burglar resistance (EN 1627): **Grade RC2 (WK2)**

Reference test 2.52 x 1.47 m / 1 sash with EVO SECURITY hardware.

Security Test: **PAS24** **Passed**

Reference test: 1.100 x 2.400 mm / 1 Sash

Classification according to North American standard (AAMA A440): **Class AW-PG60 1502 X 2502 (59 X 99) - FW**

Reference test fixed: 1.50 x 2.50 m

SECTIONS	Frame 70 mm Sash 78 mm
PROFILE THICKNESS	Window 1.5 mm Door 1.7 mm
MAXIMUM DIMENSIONS	Width (L) = 1.500 mm Height (H) = 2.600 mm
MAXIMUM WEIGHT/SASH	160 Kg

Please consult regarding maximum weight and dimensions according to types

FINISHES	Colour powder coating (RAL, mottled, rough...) According to Qualicoat >60 microns Wood effect powder coating According to Qualideco standard Anodized According to Ewwa Euras Standard Class 15 Optionally Class 20 and 25 Optionally bicoloured
----------	---

EXTRUSION ALLOY	6063 T-5
-----------------	----------

POLYAMIDE STRIP LENGTH	Polyamide 6.6 reinforced with 25% fiberglass: 32 to 35 mm
------------------------	--

GASKETS	EPDM triple gasket
---------	--------------------

FOAMS	Perimeter polyolefin foam in glazing rebate zone
-------	--

OPENING POSSIBILITIES	
INWARD	Side hung, tilt & turn, parallel sliding and tilt
OUTWARD	Side hung, top hung, pivoting on horizontal or vertical axis

CERTIFICATES	
DTA certification from CSTB lab	
Certification ATG - 3204	

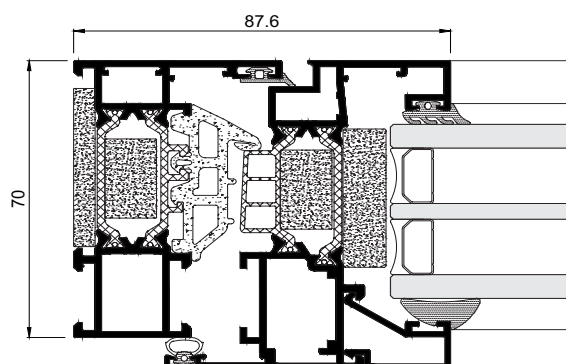

ENERGY EFFICIENCY

Thermal Transmission Coefficient
Uw ≥ 0.86 (W/m²K)

Please consult typology, dimensions and glazing.

ACCOUSTIC INSULATION

Maximum glazing: **40 mm**
Maximum acoustic insulation: **Rw = 44 dB**

CATEGORIES ACHIEVED AT TEST CENTRE

Protection against atmospheric agents

Air permeability (EN 12207):

Water tightness (EN 12208):

Wind resistance (EN 12210):

Reference test 1.23 x 1.48 m / 1 Sash

Class 4

Class E1650

Class C5

SECTIONS	Frame 70 mm Sash 78 mm
PROFILE THICKNESS	Window 1.9 mm
MAXIMUM DIMENSIONS	Standard solution Width (L) = 1.300 mm Height (H) = 2.400 mm HD Hinges (side hung) Width (L) = 1.200 mm Height (H) = 3.500 mm
MAXIMUM WEIGHT/SASH	160 Kg
Please consult maximum dimensions according to types.	
FINISHES	Colour powder coating (RAL, mottled, rough...) According to Qualicoat >60 microns Wood effect powder coating According to Qualideco standard Anodized According to Ewwa Euras Standard Class 15 Optionally Class 20 and 25 Optionally bicoloured

EXTRUSION ALLOY	6063 T-5
POLYAMIDE STRIP LENGTH	Polyamide 6.6 reinforced with 25% fiberglass: 35 mm
GASKETS	EPDM triple gasket
FOAMS	Perimeter polyolefin foam in glazing rebate zone
OPENING POSSIBILITIES	INWARD Side hung, tilt, parallel sliding and tilt & turn
CERTIFICATES	DTA certification from CSTB lab. Certification - 3204

