



**4700 IN-LINE SLIDER / LIFT & SLIDE SYSTEM**



- Up to 3 meters height
- Maximized glazed surface
- 47 mm interlock
- Faster manufacturing
- High security

**BFRC Rating**  
kWh/(m<sup>2</sup>·yr)

≥20	A	++
>10 to 20	A	+
0 to <10	A	
-10 to <0	B	
-20 to <-10	C	✓
-30 to <-20	D	
-50 to <-30	E	

Double glazing

**BFRC Rating**  
kWh/(m<sup>2</sup>·yr)

≥20	A	++
>10 to 20	A	+
0 to <10	A	
-10 to <0	B	✓
-20 to <-10	C	
-30 to <-20	D	
-50 to <-30	E	



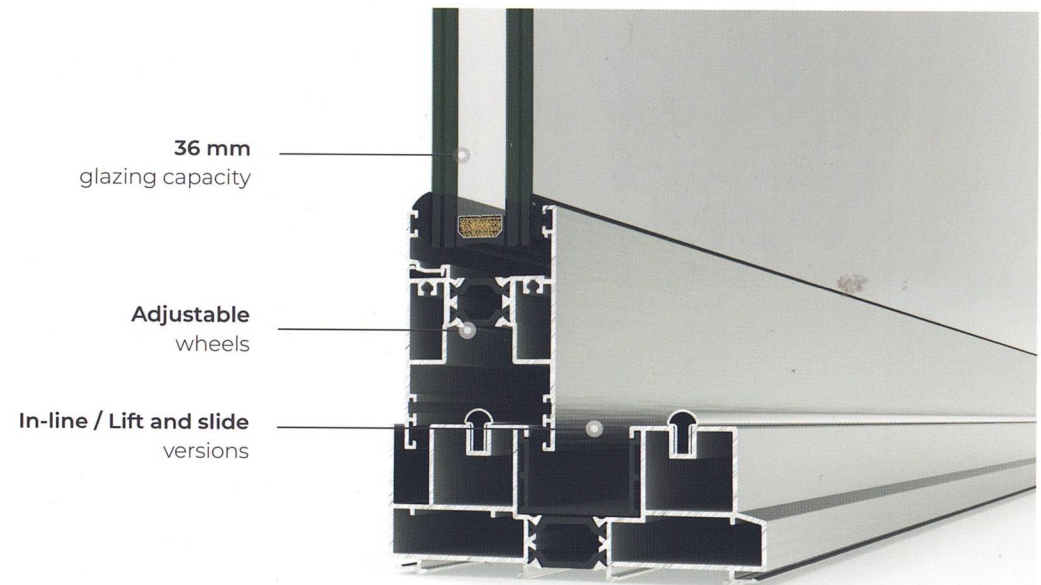

Triple glazing

This sliding system, available both in-line slider and lift & slide versions, becomes an ideal solution for closing large spans. It presents modern aesthetics in straight lines, a reduced interlock section and large glazed surfaces that ensure bright and comfortable areas, due to its thermal and acoustic performance.



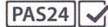

## FEATURES

U value (I)		Double glazing Uw from 1.4 (W/m <sup>2</sup> K)	Triple glazing Uw ≥ 1.2 (W/m <sup>2</sup> K)
Acoustic insulation		Rw up to 40 dB	
Air permeability		Class 3* / 4**	
Water tightness		Class 7A	
Wind resistance		Class C5* / C2**	
Security test		Passed	

Double glazing Ug=1.0 / Triple glazing Ug=0.7

(I) Two sashes 5 m x 3 m



In-line Slider



Lift & Slide

\* Reference slide test 1,8 x 2,2 m / 2 sashes / \*\* Reference lift & slide test 4,0 x 2,50 m / 2 sashes  
Security test: Reference test 2,40 x 2,40 m / 2 sashes



### IN-LINE SLIDER

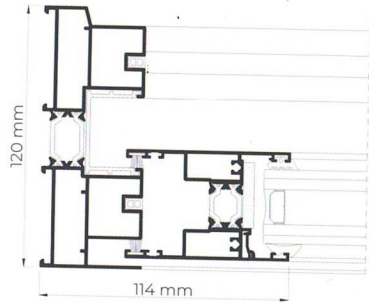

### LIFT & SLIDE

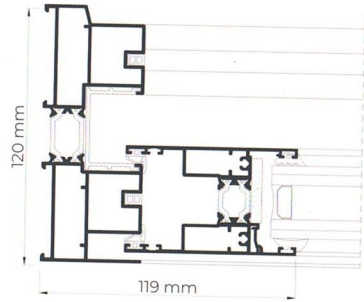

### DRAINAGE SOLUTIONS

#### Hidden Drainage

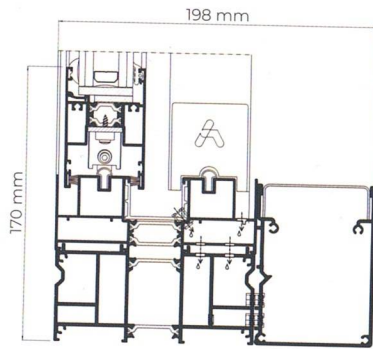

#### 250 mm Subcill

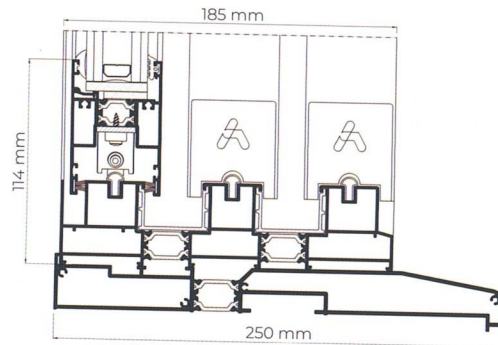

### HEAD EXTENSION - 38 mm

#### Double Track

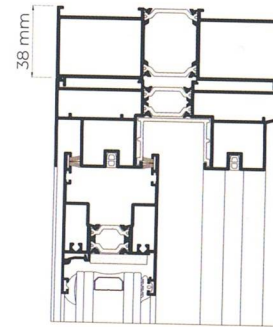

#### Triple Track

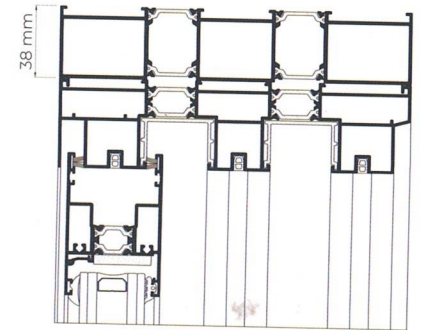

### OPENING POSSIBILITIES

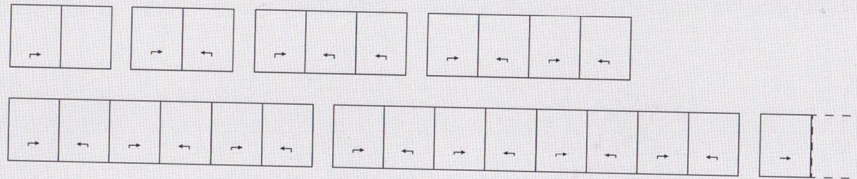

- Sliding
- 1 rail (1 sash + 1 fixed light)
- 2, 3 & 4 rails
- In-pocket

### POSSIBILITIES

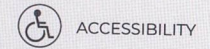

## 4700 IN-LINE SLIDER / LIFT & SLIDE

SYSTEM

---

### Sightlines

Frame depths 115 and 120 mm, 185 mm 3 rails

Interlock 47 mm

### Polyamide Strip Length

20-25 mm

### Profile Thickness

Balcony 1.5 mm

### Glazing

Max. 36 mm, Min. 26 mm

### Maximum Sash Dimensions

Width (L) 2500 mm, Height (H) 3000 mm

### Maximum Sash Weight

Slide 280 Kg

Lift & Slide 300 Kg

Consult maximum weight and dimensions according to typologies







# 4700

# IN-LINE SLIDER / LIFT & SLIDE TBB

## ENERGY EFFICIENCY

Thermal Transmission Coefficient

**Uw ≥ 1.0 (W/m²K)**

Please consult typology, dimensions and glazing.

## ACCOUSTIC INSULATION

Maximum glazing: **36 mm**

Maximum acoustic insulation: **Rw = 40 dB**

## CATEGORIES ACHIEVED AT TEST CENTRE

Protection against atmospheric agents

Air permeability (EN 12207):

**Class 3\* / 4\*\***

Water tightness (EN 12208):

**Class 7A**

Wind resistance (EN 12210):

**Class C5\* / C2\*\***

\* Reference in-line slider test 1,8 x 2,2 m / 2 sashes

\*\* Reference lift & slide test 4,0 x 2,50 m / 2 sashes

Security Test: PAS24

**Passed**

Reference test 2,40 x 2,40 m / 2 sashes

SECTIONS	Frame 120 mm and 115 mm Three-rail 185 mm Sash 50 mm
PROFILE THICKNESS	Balcony 1.5 mm
MAXIMUM DIMENSIONS	Width (L) = 2.500 mm Height (H) = 3.000 mm
MAXIMUM WEIGHT/SASH	Slide 280 Kg Lift & Slide 300 Kg

Please consult maximum dimensions according to types.

EXTRUSION ALLOY	6063 T-5
POLYAMIDE STRIP LENGTH	Polyamide 6.6 reinforced with 25% fiberglass : 20 y 25 mm
OPENING POSSIBILITIES	Sliding of 2, 3, 4, 6 & 8 sashes 1 rail (1 sash + 1 fixed light) 2, 3 & 4 rails Galandage 1, 2, 3 & 4 sashes

## FINISHES

Colour powder coating  
(RAL, mottled, rough...)

According to Qualicoat > 60 microns

Wood effect powder coating

According to Qualideco standard

Anodized

According to Ewwa Euras

Standard Class 15

Optionally Class 20 and 25

Optionally bicoloured

