



# ALUNA SLIDER

Luxury silky smooth aluminium sliding doors from **ALUNET**  
SYSTEMS



**QUALICOAT  
ASSURED  
POWDER  
COATED**

**1.4  
U-VALUE**

**ULTRA  
SLIM  
SIGHTLINES**

**PAS24  
COMPLIANT  
2022**

**ENERGY  
RATED  
C**





# ALUNA Slider

The ALUNA slider is not only a visually stunning addition to your home, it can also add huge value to the property.

Excellent thermal performance and strong, super-slim profile sections to minimise the visible framework are key to the aluminium sliding door's design.

Engineering-grade hardware allows for silky-smooth opening and closing operation. Designed with bottom rails of 42mm and 34mm wide, the slider provides stunning unobstructed views.

What's more, all our doors are rigorously tested to European safety standards and powder coated to Qualicoat's specifications, for complete peace of mind.

- Market-leading sash sizes of up to 2.5m x 2.7m per sash
- Minimal, super-slim sightlines of just 25mm or 50mm
- Double and triple track options available
- Inline slider as standard with the option of lift and slide
- Wide variety of configurations achievable
- Maximum weatherproofing and security
- PAS24:2022 compliant



Sleek

---

Strong

---

Secure

Luxury marine grade aluminium sliding doors designed to a high specification; unrivalled strength and durability, thermally efficient, safe and secure, all without compromising Aluna's highly attractive modern style.



## WHY CHOOSE ALUMINIUM?

ALUNA encompasses an exclusive range of market-leading luxury marine grade aluminium products.

Aluminium is known as the highest-quality material on the market, renowned for its durability and hard-wearing materials. Aluminium doors and windows can be maintained for decades due to their high resistance to the elements. Aluminium is also extremely strong, providing a increased security in every home.







ENERGY  
RATED  
**C**

**PAS24**  
COMPLIANT  
2022

**ULTRA  
SLIM**  
SIGHTLINES

**1.4**  
U-VALUE

**EN  
TESTED**  
FOR SAFETY



# Luxury Aluminium Sliding Doors

ALUNA Sliding Doors perfectly frame and enhance an outdoor view while creating a light and bright indoor space in your home. Transform an entire wall into a glass door, with the added freedom of accessibility, creating a seamless connection between the indoors and outdoors.

With interlock options of just 25mm or 50mm available, these super-slim options allow for maximum views, excellent thermal performance, noise reduction, high security, and weatherproofing.

Designed for large spaces, single, double and triple track options are available, allowing for a variety of opening configurations.

All of our products can be finished in several glazing options to create a style to suit any property. Our sliding door range is available with the following glazing options:

- Double glazed
- Integral blinds
- Laminated glass
- ... and many more!



**ENERGY** **ALUNA**

---

Manufacturer: **ALUNA**  
Model: **ALUNA Sliding Door**

---

A B C D E F G

C

---

**ENHANCED SECURITY**  
**PAS 24**  
PEACE OF MIND - PAS 24: 2022 CERTIFIED

If you're looking to enhance the aesthetic appeal and functionality of your home, ALUNA sliding doors are the perfect solution. They're not only visually pleasing but also offer easy access to outdoor living spaces. Whether you have a beautiful garden or a cosy balcony, these doors allow you to bring the outdoors inside with ease.

The system is designed for large opening sizes, with market-leading sash sizes achievable of up to 2.5m x 2.7m per pane. Paired with a super-slim interlock of just 25mm, the design offers impressive expanses of uninterrupted views.

With improved features designed for the UK market, the ALUNA Slider also offers excellent thermal performance, with U-values as low as 1.4 U/m<sup>2</sup>K. Noise reduction and high security to PAS24 standards are also beneficial features of these modern doors.

The ALUNA sliding door has been designed to accommodate double and triple-glazed units and blinds in glass. Innovative engineering allows for vast expanses of glass to create an impressive view and visual impact.

There is a perfect solution for every project with the ALUNA sliding door system. Choose from a wide variety of configurations, depending on the number of panes chosen and which panes you would like sliding or fixed.



<b>Market maximum sash size</b>	2.5m x 2.7m
<b>Maximum sash weight per door leaf</b>	250kg
<b>Interlock sightlines</b>	25mm/50mm
<b>Double track outer frame width</b>	120mm
<b>Triple track outer frame width</b>	183mm





## TECHNICAL DETAILS AT A GLANCE

- ❑ Super-slim 25mm interlock or 50mm non-bonded interlock available
- ❑ Double & triple track option
- ❑ Security tested to PAS24:2022
- ❑ U values as low as 1.4 U/Wm<sup>2</sup>K
- ❑ Multi-locking mechanism
- ❑ Stainless steel lamina on rail profiles for smooth sliding operation
- ❑ Trickle vents can be added
- ❑ PVC rail cover for added thermal insulation and water protection
- ❑ Two levels of channelling water and rubber tubular gaskets providing a robust seal and improved drainage

**10**  
**YEAR**  
GUARANTEE

**1.4**  
U-VALUE

**PAS24**  
COMPLIANT  
2022

ENERGY  
RATED  
**C**

# Colours

Our ALUNA Sliders are available in three standard colours, plus two dual colour options.

The standard colours available are Grey 7016 (Matte), Black (Matte), White 9016 (Gloss), Grey 7016 (Matte) on White 9016 (Gloss), and Black 9005 (Matte) on White 9016 (Gloss).

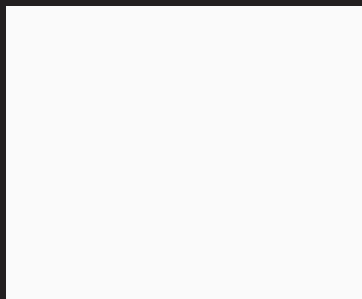

White  
RAL9016

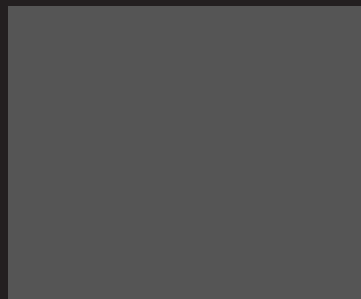

Anthracite Grey  
RAL7016



Black  
RAL9005

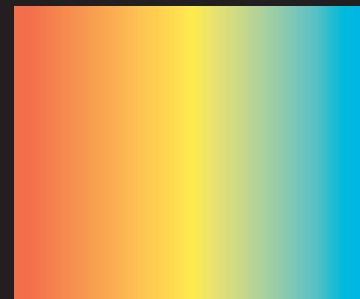

Bespoke RAL  
Colour



Grey Out/  
White In



Black Out/  
White In

For projects requiring bespoke coloured doors, any RAL colour is available upon request.



# HARDWARE AND SECURITY

## Sleek complementary hardware for ALUNA Sliders

The super-slim ALUNA Slider comes with a range of high-security hardware available in a variety of colours.

Combined with a high-security multipoint locking system, the Slider provides safety and security. Check with your manufacturer to see which hardware options they offer.

### CORNICHE SLIDER HANDLE

Creating a clean & robust finish



### CORNICHE LIFT & SLIDE HANDLE

For elegant operation & durability

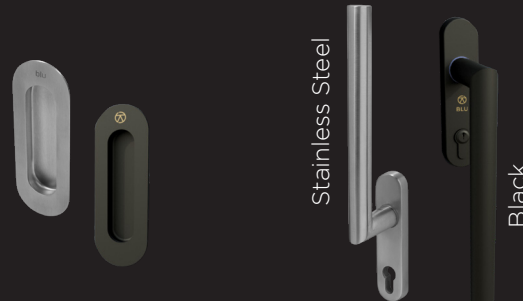

The stainless steel Corniche handles exemplify premium hardware solutions, bringing a taste of contemporary elegance and smooth, effortless door operations. Crafted from high-quality stainless steel, these handles not only make a striking visual statement but also deliver remarkable performance.

### PROLINEA SLIDER HANDLES

Timeless sophistication

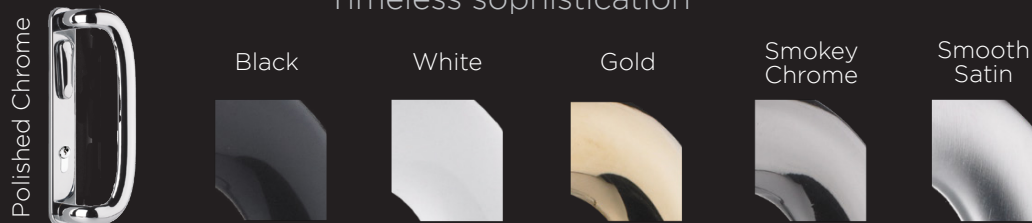

The polished Prolinea slider handles are designed to complement the soft appearance of the slider's super-slim sightlines and smooth operations. Available in 5 stunning polished colours.

## CILLS

Designed by experts to take large weights and spans, these cills are specifically suited to the ALUNA sliding door system. They direct water away from the brickwork while also providing additional detailing to the aesthetics of the door.

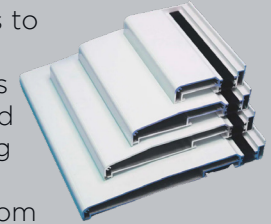

The cills also provide concealed drainage to efficiently manage water runoff and maintain a clean and unobtrusive appearance.

Cill sizes are available in 190mm and 230mm in our standard and dual colours, or any RAL colour upon request.

## SUPER-SLIM INTERLOCKS

Our market-leading 25mm super-slim, one-piece interlock is made out of robust aluminium and can be used with the inline slider, no matter the size of door.

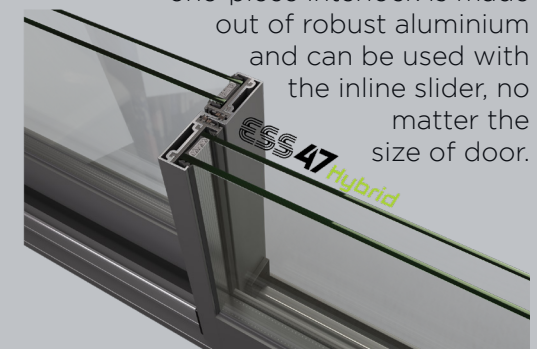

# ALUNA SLIDER

Luxury Aluminium By



T: 01924 350 110

[info@alunetsystems.co.uk](mailto:info@alunetsystems.co.uk)

[www.alunetsystems.co.uk](http://www.alunetsystems.co.uk)



Alunet Systems  
Low Mill Lane, Havelock Street  
Ravensthorpe Industrial Estate  
Ravensthorpe  
Dewsbury  
WF13 3LN





**4700 IN-LINE SLIDER / LIFT & SLIDE SYSTEM**





- Up to 3 meters height
- Maximized glazed surface
- 47 mm interlock
- Faster manufacturing
- High security

**BFRC Rating**  
kWh/(m<sup>2</sup>·yr)

≥20	A	++
>10 to 20	A	+
0 to <10	A	
-10 to <0	B	
-20 to <-10	C	✓
-30 to <-20	D	
-50 to <-30	E	

Double glazing

**BFRC Rating**  
kWh/(m<sup>2</sup>·yr)

≥20	A	++
>10 to 20	A	+
0 to <10	A	
-10 to <0	B	✓
-20 to <-10	C	
-30 to <-20	D	
-50 to <-30	E	

Triple glazing



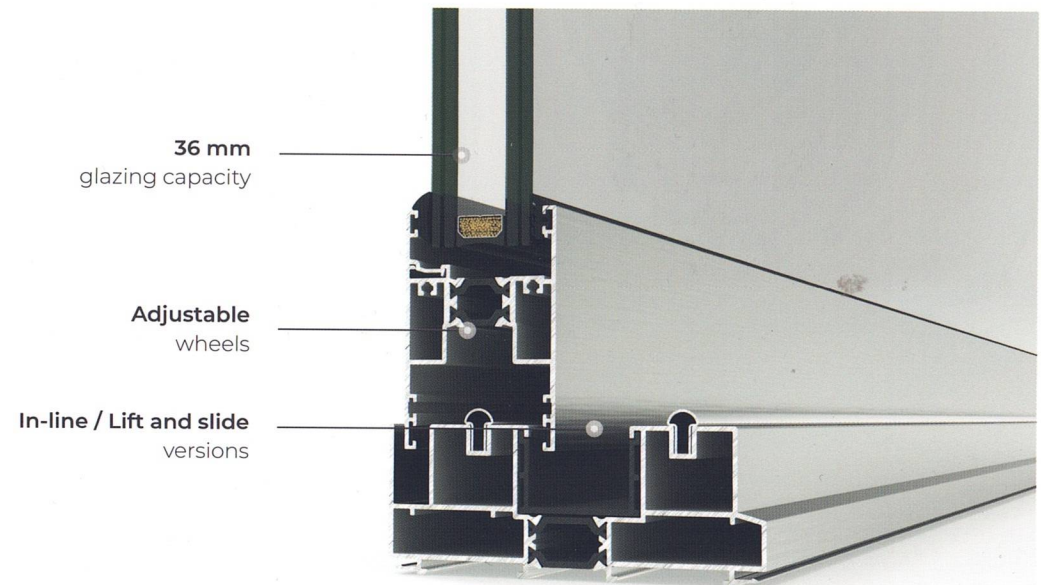

This sliding system, available both in-line slider and lift & slide versions, becomes an ideal solution for closing large spans. It presents modern aesthetics in straight lines, a reduced interlock section and large glazed surfaces that ensure bright and comfortable areas, due to its thermal and acoustic performance.





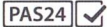

## FEATURES

U value (I)		Double glazing Uw from 1.4 (W/m <sup>2</sup> K)	Triple glazing Uw ≥ 1.2 (W/m <sup>2</sup> K)
Acoustic insulation		Rw up to 40 dB	
Air permeability		Class 3* / 4**	
Water tightness		Class 7A	
Wind resistance		Class C5* / C2**	
Security test		Passed	

Double glazing Ug=1.0 / Triple glazing Ug=0.7

(I) Two sashes 5 m x 3 m



In-line Slider

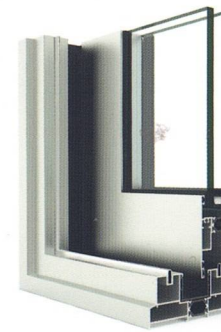

Lift & Slide

\* Reference slide test 1,8 x 2,2 m / 2 sashes / \*\* Reference lift & slide test 4,0 x 2,50 m / 2 sashes  
Security test: Reference test 2,40 x 2,40 m / 2 sashes





**IN-LINE SLIDER**

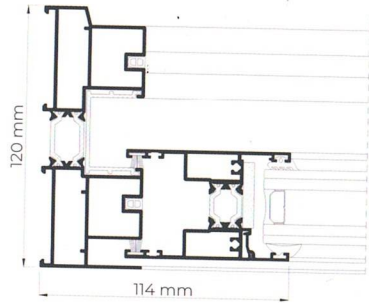

**LIFT & SLIDE**

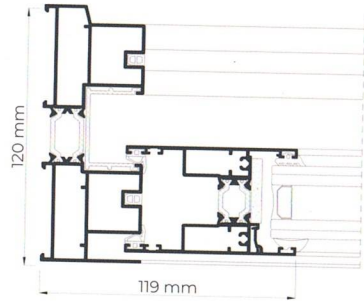

**DRAINAGE SOLUTIONS**

**Hidden Drainage**

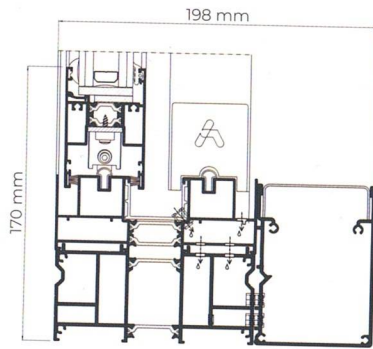

**250 mm Subcill**

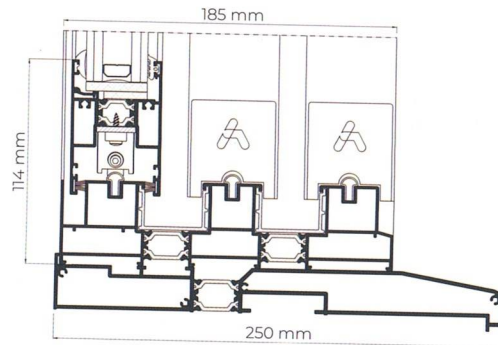

**HEAD EXTENSION - 38 mm**

**Double Track**

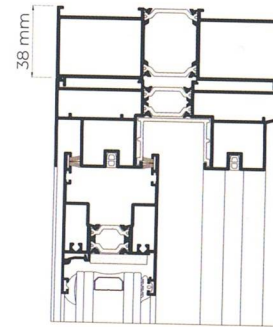

**Triple Track**

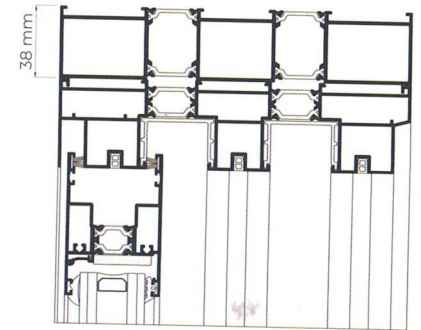

**OPENING POSSIBILITIES**

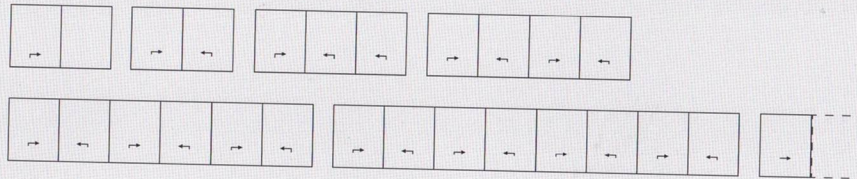

- Sliding
- 1 rail (1 sash + 1 fixed light)
- 2, 3 & 4 rails
- In-pocket

**POSSIBILITIES**

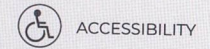



## 4700 IN-LINE SLIDER / LIFT & SLIDE

SYSTEM

---

### Sightlines

Frame depths 115 and 120 mm, 185 mm 3 rails

Interlock 47 mm

### Polyamide Strip Length

20-25 mm

### Profile Thickness

Balcony 1.5 mm

### Glazing

Max. 36 mm, Min. 26 mm

### Maximum Sash Dimensions

Width (L) 2500 mm, Height (H) 3000 mm

### Maximum Sash Weight

Slide 280 Kg

Lift & Slide 300 Kg

Consult maximum weight and dimensions according to typologies









# 4700

## IN-LINE SLIDER / LIFT & SLIDE TBB

### ENERGY EFFICIENCY

Thermal Transmission Coefficient

**Uw ≥ 1.0 (W/m²K)**

Please consult typology, dimensions and glazing.

### ACCOUSTIC INSULATION

Maximum glazing: **36 mm**

Maximum acoustic insulation: **Rw = 40 dB**

### CATEGORIES ACHIEVED AT TEST CENTRE

Protection against atmospheric agents

Air permeability (EN 12207):

**Class 3\* / 4\*\***

Water tightness (EN 12208):

**Class 7A**

Wind resistance (EN 12210):

**Class C5\* / C2\*\***

\* Reference in-line slider test 1,8 x 2,2 m / 2 sashes

\*\* Reference lift & slide test 4,0 x 2,50 m / 2 sashes

Security Test: PAS24

**Passed**

Reference test 2,40 x 2,40 m / 2 sashes

SECTIONS	Frame 120 mm and 115 mm Three-rail 185 mm Sash 50 mm
PROFILE THICKNESS	Balcony 1.5 mm
MAXIMUM DIMENSIONS	Width (L) = 2.500 mm Height (H) = 3.000 mm
MAXIMUM WEIGHT/SASH	Slide 280 Kg Lift & Slide 300 Kg

Please consult maximum dimensions according to types.

EXTRUSION ALLOY
6063 T-5
POLYAMIDE STRIP LENGTH
Polyamide 6.6 reinforced with 25% fiberglass : 20 y 25 mm
OPENING POSSIBILITIES
Sliding of 2, 3, 4, 6 & 8 sashes 1 rail (1 sash + 1 fixed light) 2, 3 & 4 rails Galandage 1, 2, 3 & 4 sashes

### FINISHES

Colour powder coating  
(RAL, mottled, rough...)

According to Qualicoat > 60 microns

Wood effect powder coating

According to Qualideco standard

Anodized

According to Ewwa Euras

Standard Class 15

Optionally Class 20 and 25

Optionally bicoloured

