

## ENERGY EFFICIENCY

Thermal Transmission Coefficient  
 **$U_w \geq 0.76 (W/m^2K)$**

Please consult typology, dimensions and glazing

## ACCOUSTIC INSULATION

Maximum glazing: **63 mm**  
 Maximum acoustic insulation:  **$R_w = 44 \text{ dB}$**

## CATEGORIES ACHIEVED AT TEST CENTRE

Protection against atmospheric agents

Air permeability (EN 12207): **Class 4**  
 Water tightness (EN 12208): **Class E1800**  
 Wind resistance (EN 12210): **Class C5**

Reference test 1.23 x 1.48 m / 2 sashes

Burglar resistance (EN 1627): **Grade RC2 (WK2)**

Reference test 2.52 x 1.47 m / 1 sash with EVO SECURITY hardware.

Security Test: **PAS24**  **Passed**

Reference test: 1.100 x 2.400 mm / 1 Sash

Classification according to North American standard (AAMA A440): **Class AW-PG60 1502 X 2502 (59 X 99) - FW**

Reference test fixed: 1.50 x 2.50 m

<b>SECTIONS</b>	Frame 70 mm Sash 78 mm
<b>PROFILE THICKNESS</b>	Window 1.5 mm Door 1.7 mm
<b>MAXIMUM DIMENSIONS</b>	Width (L) = 1.500 mm Height (H) = 2.600 mm
<b>MAXIMUM WEIGHT/SASH</b>	160 Kg

Please consult regarding maximum weight and dimensions according to types

<b>FINISHES</b>	Colour powder coating (RAL, mottled, rough...) According to Qualicoat >60 microns Wood effect powder coating According to Qualideco standard Anodized According to Ewwa Euras Standard Class 15 Optionally Class 20 and 25 Optionally bicoloured
-----------------	---

<b>EXTRUSION ALLOY</b>	6063 T-5
------------------------	----------

<b>POLYAMIDE STRIP LENGTH</b>	Polyamide 6.6 reinforced with 25% fiberglass: 32 to 35 mm
-------------------------------	--

<b>GASKETS</b>	EPDM triple gasket
----------------	--------------------

<b>FOAMS</b>	Perimeter polyolefin foam in glazing rebate zone
--------------	--

<b>OPENING POSSIBILITIES</b>	
<b>INWARD</b>	Side hung, tilt & turn, parallel sliding and tilt
<b>OUTWARD</b>	Side hung, top hung, pivoting on horizontal or vertical axis

<b>CERTIFICATES</b>	
DTA certification from CSTB lab	
Certification ATG - 3204	

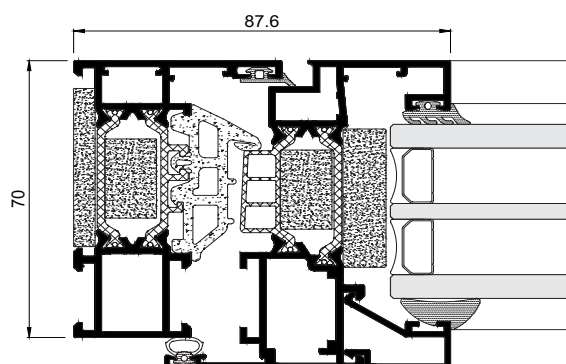

## ENERGY EFFICIENCY

Thermal Transmission Coefficient  
 **$U_w \geq 0.86$  (W/m<sup>2</sup>K)**

Please consult typology, dimensions and glazing.

## ACCOUSTIC INSULATION

Maximum glazing: **40 mm**  
Maximum acoustic insulation: **Rw = 44 dB**

## CATEGORIES ACHIEVED AT TEST CENTRE

Protection against atmospheric agents

Air permeability (EN 12207):

Water tightness (EN 12208):

Wind resistance (EN 12210):

Reference test 1.23 x 1.48 m / 1 Sash

**Class 4**

**Class E1650**

**Class C5**

<b>SECTIONS</b>	Frame 70 mm Sash 78 mm	<b>EXTRUSION ALLOY</b>	6063 T-5
<b>PROFILE THICKNESS</b>	Window 1.9 mm	<b>POLYAMIDE STRIP LENGTH</b>	Polyamide 6.6 reinforced with 25% fiberglass: 35 mm
<b>MAXIMUM DIMENSIONS</b>	Standard solution Width (L) = 1.300 mm Height (H) = 2.400 mm  HD Hinges (side hung) Width (L) = 1.200 mm Height (H) = 3.500 mm	<b>GASKETS</b>	EPDM triple gasket
<b>MAXIMUM WEIGHT/SASH</b>	160 Kg	<b>FOAMS</b>	Perimeter polyolefin foam in glazing rebate zone
Please consult maximum dimensions according to types.		<b>OPENING POSSIBILITIES</b>	
<b>FINISHES</b>	Colour powder coating (RAL, mottled, rough...) According to Qualicoat >60 microns Wood effect powder coating According to Qualideco standard Anodized According to Ewwa Euras Standard Class 15 Optionally Class 20 and 25 Optionally bicoloured	<b>INWARD</b>	Side hung, tilt, parallel sliding and tilt & turn
		<b>CERTIFICATES</b>	
		DTA certification from CSTB lab.	 
		Certification - 3204	

